

Maritimo®

Australian built long-range luxury cruisers

When you consider that Australia is the world's biggest island, it comes as no surprise that it's home to the new Maritimo Offshore, one of the world's finest long-range luxury cruisers.

After all, with a coastline measuring almost 60,000km in length, and facing the might of the Indian, Southern and Pacific oceans', you can't afford to compromise on engineering, performance or quality.



RANGE SUMMARY

SEPTEMBER 2010

For the discerning voyager

From the awesome power of twin Marine Diesels to the swathe of lavish appointments from the water up, everything aboard a Maritimo has been designed with one thing in mind : long-range luxury cruising.

In fact, no other cruiser looks, feels or performs like a Maritimo. It simply manages to be both timeless and ahead of its time. It truly is oceans apart.

CRUISING ENCLOSED FLYBRIDGE

M48



KEY SPECIFICATIONS

Length Overall	15.7M (51'6")
Beam	5.2M (17'1")
Draft	1.3M (4'3")
Fuel	3,500L
Water	800L
Holding Tank	300L
Cruise Speed Top	25 Knots
Speed	30.5 Knots
Std Engines	2 x Cummins QSC8.3 600MHP
Sleeping Capacity	6 standard
RCD Category	Cat A - 26 People
Price From	£poa

M53



Length Overall	17.6M (57'9")
Beam	5.2M (17'1")
Draft	1.35M (4'4")
Fuel	3,850L
Water	800L
Holding Tank	300L
Cruise Speed Top	25 Knots
Speed	30 Knots
Std Engines	2 x Cummins QSM11 715MHP
Sleeping Capacity	6 standard
RCD Category	Anticipated Cat A - 26 People
Price From	£poa

M56



Length Overall	18.5M (60'6")
Beam	5.2M (17'1")
Draft	1.35M (4'4")
Fuel	3,850L
Water	670L
Holding Tank	300L
Cruise Speed Top	25 Knots
Speed	33 Knots
Std Engines	2 x Caterpillar C12 715MHP
Sleeping Capacity	5 standard
RCD Category	Anticipated Cat A - 26 People
Price From	£poa

M60



KEY SPECIFICATIONS

Length Overall	18.7M (61'4")
Beam	5.6M (18'5")
Draft	1.4M (4'7")
Fuel	6,500L
Water	1,500L
Holding Tank	300L
Cruise Speed Top	25 Knots
Speed	33 Knots
Std Engines	2 x Caterpillar C18 1015MHP
Sleeping Capacity	6 standard
RCD Category	Anticipated Cat A - Min 26 People
Price From	£poaT

M73



Length Overall	24.8M (81'4")
Beam	6.68M (21'11")
Draft	1.55M (5'1")
Fuel	10,900L
Water	1,700L
Holding Tank	600L
Cruise Speed Top	30 Knots
Speed	TBC
Std Engines	2 x Caterpillar C32 1570MHP
Sleeping Capacity	7 standard
RCD Category	TBC
Price From	£poa

CRUISING ENCLOSED FLYBRIDGE

- * Unique helm position with tremendous visibility "The most comfortable steering position" as quoted by a professional skipper.
- * Increased undercover living space (Flybridge as second saloon)
- * Internal staircase
- * RCD Cat "A" for 26 people
- * Huge cruising ranges
- * Maximum speed up to 33 knots

All Maritimo Motor cruisers have a small keel and shallow shaft angles for a smooth semi displacement ride, improved fuel efficiencies and high RCD ratings offering huge rough weather capabilities.

AEGEAN OPEN FLYBRIDGE

A50



KEY SPECIFICATIONS

Length Overall	16.1M (52'9")
Beam	5.2M (17'1")
Draft	1.3M (4'3")
Fuel	2,600L
Water	800L
Holding Tank	300L
Cruise Speed Std	25 Knots
Engines Sleeping	2 x Cummins QSC8.3 600MHP
Capacity	5 standard
Price	£poa
From	£poa

A55



Length Overall	17.62M (57'9")
Beam	5.2M (17'1")
Draft	1.3M (4'3")
Fuel	3,600L
Water	800L
Holding Tank	300L
Cruise Speed Std	26 Knots
Engines Sleeping	2 x Cummins QSC11 715MHP
Capacity	6 standard
Price	£poa
From	£poa

A60

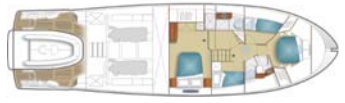

Length Overall	19.11M (62'8")
Beam	5.2M (17'1")
Draft	1.3M (4'3")
Fuel	5,600L
Water	800L
Holding Tank	300L
Cruise Speed Std	25 Knots
Engines Sleeping	2 x Caterpillar C12 715MHP
Capacity	6 standard
Price	£poa
From	£poa

AEGEAN ENCLOSED FLYBRIDGE

A50E



KEY SPECIFICATIONS

Length Overall	16.1M (52'9")
Beam	5.2M (17'1")
Draft	1.3M (4'3")
Fuel	2,600L
Water	800L
Holding Tank	300L
Cruise Speed Std	24 Knots
Engines Sleeping	2 x Cummins QSC8.3 600MHP
Capacity	5 standard
Price	£poa
From	£poa

A60E



Length Overall	19.11M (62'8")
Beam	5.2M (17'1")
Draft	1.3M (4'3")
Fuel	5,600L
Water	800L
Holding Tank	300L
Cruise Speed Std	25 Knots
Engines Sleeping	2 x Caterpillar C12 715MHP
Capacity	5 standard
Price	£poa
From	£poa

AEGEAN OPEN AND ENCLOSED FLYBRIDGE

Decide on the hull size, then decide if you like the Sports, Open Flybridge or Enclosed Flybridge design.

All Aegean models feature :

- * Tender Garaging
- * Dead rise semi-displacement hull
- * Sociable airy design
- * Kitchens aft of the saloon and near the external cockpit
- * Capable of rough weather conditions
- * Long cruising ranges

All Maritimo Motor cruisers are ergonomically designed with a keel and shallow shaft angles for a smooth ride and offering improved fuel efficiencies.

SPORTS CABRIOLET

C47

C50

C55

C60

KEY SPECIFICATIONS

Length Overall	15.43M (50'7")	16.11M (52'10")	17.62M (57'10")	19.11M (62'8")
Beam	4.85M (15'11")	5.2M (17'1")	5.2M (17'1")	5.2M (17'1")
Draft	1M (3'3")	1.3M (4'3")	1.3M (4'3")	1.3M (4'3")
Fuel	1,800L	2,600L	3,600L	5,600L
Water	400L	800L	800L	800L
Holding Tank	300L	300L	300L	300L
Cruise Speed Std	25 Knots	25 Knots	25 Knots	25 Knots
Engines Sleeping	2 x Volvo IPS600 435MHP	2 x Cummins QSC8.3 600MHP	2 x Cummins QSM11 715MHP	2 x Caterpillar C12 715MHP
Capacity	5 standard	5 standard	6 standard	6 standard
Price From	£poa	£poa	£poa	£poa

SPORTS CONVERTIBLE

440

470

500

550

KEY SPECIFICATIONS

Length Overall	14.8M (48'7")	16.5M (54'1")	16.5M (54'1")	17.8M (58'4")
Beam	4.68M (15'4")	5M (16'5")	5.2M (17'1")	5.2M (17'1")
Draft	1.1M (3'7")	1.2M (4')	1.3M (4'3")	1.3M (4'3")
Fuel	1,800L	3,000L	3,500L	3,600L
Water	400L	400L	800L	1,200L
Holding Tank	300L	300L	300L	300L
Cruise Speed Std	25 Knots	25 Knots	25 Knots	25 Knots
Engines Sleeping	2 x Volvo IPS600 435MHP	2 x Cummins QSC8.3 600MHP	2 x Cummins QSC8.3 600MHP	2 x Caterpillar C12 715MHP
Capacity	5 standard (6 optional)	5 standard	6 standard	6 standard
Price From	£poaT	£poa	£poa	£poa

Prices quoted are ex-works Maritimo Brisbane factory. Shipping and Commissioning are extra.

The information on the products contained within is correct at the time of printing. Maritimo reserves the right to vary prices and specifications with or without notice and at such times in such manner as they see fit. We would recommend you check our website www.maritimo.co.uk for any updates not contained in this publication.