

# Maritimo®

Retail Price List  
Valid from 22 April 2010

## 48 Cruising Flybridge

### Specification

LOA	15.70m	51' 6"
BEAM	5.2m	17' 11"
DRAFT	1.33m	4' 2"
FUEL	3,600 litres	778 gallons
WATER	800 litres	178 gallons
WEIGHT	22,000 kg	48,400lbs
ENGINE	2 x VOLVO D12-800 775MHP	
SPEED	CRUISE 26 Knots MAX 30.5 Knots	
BERTHS	6 berths in 3 cabins	
RCD CATEGORY	RATED "A" FOR 26 PERSONS	

CRUISING RANGE	KNOTS	NM
Range figures are an indication only. Calculated on 3,240 litres of fuel or 90% of 3,600 litres	8	1,480
	10	600
	17	500
	25	480
	30	400

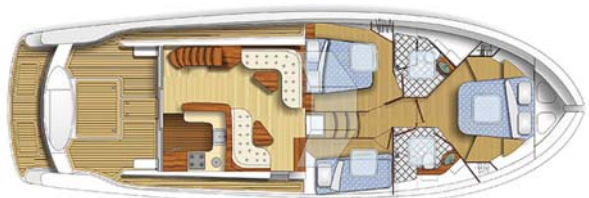

cockpit / saloon / accommodation



cruising flybridge - skylounge



*"The feeling of power from the twin marine diesels, or the luxurious comfort surrounding you from the water up, everything aboard a Maritimo has been designed with one thing in mind. Long range luxury cruising. In fact, no other cruiser looks, feels or performs like a Maritimo. It manages to be both timeless and ahead of its time."*



# 48



## Options 1

### BOAT / ENGINE CHOICE

- Maritimo 48 Cruising Flybridge - Sky Lounge (Volvo D12-800 775MHP, 17.5kw Cat gen set)  
Engine upgrade a : Cummins QSM11 670MHP, 17.5kw Onan gen set  
Engine upgrade b : Cat C12 715MHP, 17.5kw Cat gen set

	EX VAT	INC 17.5% UK VAT
<input type="checkbox"/>	£775,724.26	£911,476
<input type="checkbox"/>	£0.00	£0
<input type="checkbox"/>	£24,872.34	£29,225

### LOWER STATION

- Engine & bow thruster controls
- Steering wheel
- Electric engine display
- Windscreen wiper & washer x 1 front glass
- Windscreen wiper & washer x 2 front glass
- Switch panel for trim tabs / winch / horn etc (10 switches)

<input type="checkbox"/>	£2,582.98	£3,035
<input type="checkbox"/>	£2,570.21	£3,020
<input type="checkbox"/>	£5,080.85	£5,970
<input type="checkbox"/>	£1,591.49	£1,870
<input type="checkbox"/>	£2,778.72	£3,265
<input type="checkbox"/>	£451.06	£530

### FLYBRIDGE AFT OUTSIDE STATION (PORT SIDE)

- Engine & bow thruster controls
- Steering wheel

<input type="checkbox"/>	£2,595.74	£3,050
<input type="checkbox"/>	£2,595.74	£3,050

### COCKPIT

- Engine controls (port side on vertical surface)
- Cockpit seating (reverse BBQ) - hydraulic bathing platform is recommended with this option
- Hydraulic bathing platform

<input type="checkbox"/>	£2,582.98	£3,035
<input type="checkbox"/>	£10,919.15	£12,830
<input type="checkbox"/>	£29,774.47	£34,985

### GENERAL

- Stainless steel framed aft saloon door
- Stern Thruster. Controls fitted to flybridge only (including remote control)
- Timber floor - Satin varnished to saloon entry only
- Timber floor - Satin varnished to saloon and galley
- Solid surface Galley Bench (top colour)
- Custom - Solid surface Galley Bench tops
- Optional gloss finish to Galley Bench
- Flybridge helm seat - Raeline - Deluxe Sports leather x 1 leather upholstered additional seat
- Flybridge helm & Co-pilot Deluxe Raeline Sports leather
- Flybridge helm & Co-pilot Navigator Pilothouse Sports Seats leather (x2)
- Water guage to galley
- Preparation for future watermaker installation (including skin fittings, shelf & power)
- Davit 200kg electric with pneumatic jib to foredeck
- Davit deluxe 350kg electric with pneumatic jib to foredeck
- Bidet toilet for master ensuite / guest bathrooms
- Bathroom airconditioning (master ensuite and guest bathroom)
- Teak laid decking - to cockpit, side decks (to steps) and swimming platform
- Teak laid decking - to flybridge aft balcony
- Teak laid decking - to flybridge interior
- Teak laid decking - to optional hydraulic bathing platform
- Cockpit stainless steel BBQ (240V)
- Cockpit flood lights x 2 mounted to aft end of hardtop
- Flybridge aft rails fitted with mud rail
- Muir chain counter (round style) - readout only
- Chain extra 20m (standard 60m grade 'L')
- Tackle locker in cockpit BBQ unit
- Live bait tank in landing platform

<input type="checkbox"/>	£8,863.83	£10,415
<input type="checkbox"/>	£6,944.68	£8,160
<input type="checkbox"/>	£1,463.83	£1,720
<input type="checkbox"/>	£5,600.00	£6,580
<input type="checkbox"/>	£1,170.21	£1,375
<input type="checkbox"/>	£2,051.06	£2,410
<input type="checkbox"/>	£263.83	£310
<input type="checkbox"/>	£3,327.66	£3,910
<input type="checkbox"/>	£4,476.60	£5,260
<input type="checkbox"/>	£5,557.45	£6,530
<input type="checkbox"/>	£659.57	£775
<input type="checkbox"/>	£944.68	£1,110
<input type="checkbox"/>	£7,897.87	£9,280
<input type="checkbox"/>	£9,378.72	£11,020
each <input type="checkbox"/>	£778.72	£915
<input type="checkbox"/>	£570.21	£670
<input type="checkbox"/>	£13,459.57	£15,815
<input type="checkbox"/>	£3,919.15	£4,605
<input type="checkbox"/>	£4,668.09	£5,485
<input type="checkbox"/>	£3,131.91	£3,680
<input type="checkbox"/>	£2,080.85	£2,445
<input type="checkbox"/>	£327.66	£385
<input type="checkbox"/>	£548.94	£645
<input type="checkbox"/>	£778.72	£915
<input type="checkbox"/>	£382.98	£450
<input type="checkbox"/>	£527.66	£620
<input type="checkbox"/>	£1,378.72	£1,620

### CANVAS OPTIONS

- Breezeway windscreen cover - lower helm
- Breezeway side window covers - saloon
- Breezeway side & forward window covers - flybridge
- Cockpit carpet (4 sections) not including swimming platform
- Carpet cover - main saloon
- Carpet cover - flybridge
- Flybridge upholstery - custom fabric
- Rear awning to cockpit including clears and zippers
- Rear awning to flybridge - hardtop
- Flybridge rail covers - Strata Glass
- Deck chair storage bags on flybridge

<input type="checkbox"/>	£553.19	£650
<input type="checkbox"/>	£740.43	£870
<input type="checkbox"/>	£1,638.30	£1,925
<input type="checkbox"/>	£TBA	£TBA
<input type="checkbox"/>	£646.81	£760
<input type="checkbox"/>	£587.23	£690
<input type="checkbox"/>	£POA	£POA
<input type="checkbox"/>	£4,008.51	£4,710
<input type="checkbox"/>	£2,485.11	£2,920
<input type="checkbox"/>	£1,097.87	£1,290
<input type="checkbox"/>	£357.45	£420

Items marked • = Recommended options

## Cruising Flybridge



### Options 2

		EX VAT	INC 17.5% UK VAT
<b>INTERIOR UPGRADE</b>			
• Interior furnishing upgrade : Galley, Towels (Maritimo branded), Scatter cushions, Bed spreads, Carpets etc	<input type="checkbox"/>	£7,719.15	£9,070
• Leather Tub Chair for saloon	each <input type="checkbox"/>	£655.32	£770
• Leather Footstool for saloon	each <input type="checkbox"/>	£289.36	£340
<b>FLYBRIDGE</b>			
• Webasto sunroof with tinted glass and blind (note : alternative sunroofs available - costs differ)	<input type="checkbox"/>	£10,421.28	£12,245
• Wood burl grain effect dash & armrest panels on helm	<input type="checkbox"/>	£953.19	£1,120
<b>FOREDECK</b>			
• Fender store (3 port & 3 starboard side)	<input type="checkbox"/>	£382.98	£450
<b>PUMPS</b>			
High pressure water blaster with cockpit outlets - Karcher	<input type="checkbox"/>	£2,242.55	£2,635
Saltwater deck wash pump (240V)	<input type="checkbox"/>	£2,000.00	£2,350
Water maker IDROMAR IDRO-MCJV : 130 litres/hour, stainless steel	<input type="checkbox"/>	£16,391.49	£19,260
<b>EXTERIOR LIGHTING</b>			
• Underwater lights - long life high output LED (blue or white)	<input type="checkbox"/>	£2,753.19	£3235
<b>PASSERELLES / CRANE</b>			
2.5m.t. polished steel hydraulic passerelle	<input type="checkbox"/>	£8,953.19	£10,520
3.0m.t. polished steel hydraulic passerelle	<input type="checkbox"/>	£9,480.85	£11,140
<b>TV ANTENNA</b>			
High bandwidth Digital TV receiver with dual antenna	<input type="checkbox"/>	£697.87	£820
Dummy KVH Tracvision M5 satellite antenna	<input type="checkbox"/>	£1,400.00	£1,645
Dummy KVH Tracvision M6 satellite antenna	<input type="checkbox"/>	£POA	£POA
Dummy KVH Tracvision M7 satellite antenna	<input type="checkbox"/>	£2,600.00	£3,055
KVH Tracvision M5 satellite TV antenna	<input type="checkbox"/>	£8,455.32	£9,935
KVH Tracvision M6 satellite TV antenna	<input type="checkbox"/>	£POA	£POA
KVH Tracvision M7 satellite TV antenna	<input type="checkbox"/>	£10,502.13	£12,340
<b>ENTERTAINMENT</b>			
15" LCD TV with mounting bracket (guest & bunk cabins)	<input type="checkbox"/>	£POA	£POA
• 20" LCD TV with mounting bracket (flybridge& master cabin)	<input type="checkbox"/>	£POA	£POA
• 32" LCD TV (saloon)	<input type="checkbox"/>	£POA	£POA
Saloon option A - Bose Lifestyle 28 with DVD/CD/Radio	<input type="checkbox"/>	£3,953.19	£4,645
• Saloon option B - Bose Lifestyle 38 with DVD/CD/Radio + 200GB Hard Disk	<input type="checkbox"/>	£4,514.89	£5,305
• Cockpit or flybridge option - Bose 131 speakers with remote control	each <input type="checkbox"/>	£1,395.74	£1,640
• Cabin option - Bose 321 with DVD/CD/Radio	each <input type="checkbox"/>	£2,280.85	£2,680
<b>INTERCOM / SECURITY CAMERA</b>			
Intercom Flybridge to galley	<input type="checkbox"/>	£497.87	£585
• Camera to engine room, aft and fwd decks including installation	<input type="checkbox"/>	£2,259.57	£2,655
<b>LIFE JACKETS (EACH)</b>			
Crewsaver - CrewFit 150N (Junior) Red Housing (Navy or red Housing) (1058-JUN)	<input type="checkbox"/>	£71.45	£83.95
Crewsaver - CrewFit 150N (Small Adult) Auto Gas Hammer Light & Hood Red & Blue (1058-Plus)	<input type="checkbox"/>	£125.91	£147.95
Crewsaver - CrewFit 275N (Adult) Auto Gas Hammer Red & Blue (1059-Hamm)	<input type="checkbox"/>	£132.72	£155.95
Crewsaver - CrewFit 275N (Adult) Auto Gas Hammer Light & Hood Red & Blue (1059-Plus)	<input type="checkbox"/>	£165.06	£193.95
Subsidised factory visit & boat collection (prior to shipping). Have the opportunity to collect your boat direct from the factory in Australia, and enjoy your new purchase before shipping it to the UK. For 2 people, including flights and 3 nights hotel accommodation in Goldcoast, Australia	<input type="checkbox"/>	£POA	£POA
<b>Items marked • = Recommended options</b>		<b>TOTAL</b>	<b>£</b>

UK Retail Price = Prices quoted are Ex.Works Hope Island, Australia. Shipping, Pre Delivery (PDI), commissioning, launching and hand over are at extra cost.  
Note : Standard shipping route is Brisbane - Australia to Tilbury - England. Alternative delivery points can be arranged.



## 48 Cruising Flybridge



### Standard Equipment

#### Construction

- Variable dead rise Deep V solid fibreglass hull
- Flybridge, Deck & Wheelhouse - fibreglass with core
- Water tight collision bulkhead
- Integral GRP fuel tank



#### Flybridge

- Access : Internal staircase from saloon
- Sliding side windows in enclosed hardtop
- Forward hopper window
- Glass rear bulkhead with sliding doors
- Stainless steel rail to rear of flybridge
- Helm station : Fully equipped with steering, engine controls, engine instrumentation, 2 x windscreen wipers & washers, bow thruster control, trim tab controls, winch up/down controls, Simrad AP26 autopilot, Icom M603 VHF radio and compass
- Individual leather upholstered deluxe helm seat
- 24,000 BTU reverse cycle airconditioning
- Forward facing de-misters x 3
- Drink holder x 2 on console
- Large dinette area with dining table and stowage under
- Ceiling lighting & mood lighting
- Entertainment : Wet bar, fridge
- Sink with hot & cold water
- Mounting positions for optional navigation domes / radar
- Spotlight remote control
- Glass & bottle storage locker



#### Saloon

- Entertainment : Full wet bar in polished timber with ice-maker
- Galley : 2 door fridge / freezer, 4 burner hob with extractor hood, integrated microwave and dishwasher drawer, stainless steel sink / drainer with mixer tap. Overhead and worktop lighting.
- Furniture : Polished timber, L-shaped dinette with leather upholstery and polished occasional folding dining table. L-shaped lounges with leather upholstery
- Access : internal staircase to flybridge. Framed opening glass door to side deck (starboard side)
- Alloy framed double sliding glass doors to cockpit
- 24,000 BTU reverse cycle airconditioning
- Blinds to side windows and aft doors
- Overhead & mood lighting, 2 x wall power sockets in galley



#### Accommodation

- Main stateroom : 5ft queen size island berth with sprung mattress with large stowage area below. Lockers in polished timber. Ensuite bathroom with shower, mirrors, vanity and fresh or salt water flush toilet. Bedside cabinets. Concealed and overhead lighting. Full length mirror behind sliding door. 2 wall sockets. 12,000 BTU reverse cycle airconditioning. Emergency escape hatches
- Forward stateroom : Island berth with sprung mattress. Full height lockers in polished timber. Bathroom with toilet, shower and vanity - shares with twin cabin. 12,000 BTU reverse cycle airconditioning. Overhead & bed head lighting
- Twin cabin : Under and over single bunks, full height locker. Air-conditioning split from master cabin. Combination washer / dryer

#### Aft Cockpit Deck

- Aft entertainment module with sink and freezer built-in
- Cockpit hot / cold shower
- Deck lighting



#### Engineering / Electrical

- Twin diesel Volvo D12-800 - 775hp engines with power steering pump (options available)
- Engine bay : fibreglass lined with acoustic insulation and fire system
- Hydraulic power steering
- Electric hydraulic trim tabs
- Bow thruster including hand held remote control
- 800 litre fresh water tank with separate water filter for galley
- 3,600 litre twin fuel tanks with emergency shut-off
- 17.5kw Cat generator supplying 24 / 240V (options available)
- 24V heavy duty winch with foredeck & flybridge controls
- Self stowing 30kg stainless steel anchor with Grade L 10mm x 60m chain
- International code compliant navigation lights
- 4 Fenders and 4 Shore lines

### 48 Cruising Flybridge - Skylounge : price from

Ex VAT: £775,724.26 Inc 17.5% UK Vat: £911,476

Every attempt has been made to give accurate information, but performance and range figures are estimates and given as a guide only. Dirt or growth on the hull, tuning of the engines, make and size of engines fitted, damage to propellers, the temperature of the air and water, the weight of fuel, water, stores, number of people, propeller pitch, quality of fuel and other matters, can all affect a boat's performance and range. For these and other reasons we can give no performance, range or any other guarantees, and neither such guarantees nor anything contained herein constitutes an offer of contract or any representation or agreement, or may otherwise be relied upon.

(A) Maritimo reserves the right to make changes at any time, without notice, in prices, material, specifications and equipment. Orders are accepted subject to prices prevailing at time of shipment. Orders requesting any material and/or equipment which differ from that selected by Maritimo as standard or optional for this model will be considered a custom change and will require additional charges. Prices shown for many options may apply only if ordered prior to start of production. Once production begins, orders for such options may require additional charges due to non-standard

installation requirements and/or lead times. In order to show equipment size and location, line drawing may include some optional items.

(B) Length overall does not include the optional swim platform or bow pulpit.

(C) Weight, draft, and freeboard are based on an estimate of model's displacement with largest engines available and all tanks filled. Heights are estimated with largest engines and all tanks empty. Actual figures will vary depending on production tolerances, equipment, supplies and stores on board, as well as operational and sea conditions. Capacities of tanks are estimated to be total capacity of all tanks normally furnished in this model. Usable capacities will vary depending upon conditions.

(D) Generator is not intended to supply power for all standard and optional accessories simultaneously. Load must be limited to generator output rating.

(E) One set of sheets includes: one bottom sheet, one top sheet, pillowcase(s)

(F) Option must be ordered prior to start of production. Price shown reflects cost of scheduled

installation requirements. A late request for this option will require an additional charge.

The photographs and artist's impressions in this brochure are of existing models in the Maritimo range. There may be items shown in these photographs and artist's impressions that are not included in the standard inventory of the models shown. Specifications contained on the web site are samples only and should not be relied upon and may refer to models only intended for sale in a particular territory and not generally. No guarantee is given that any model will be available in any territory. However by contacting us we can advise you of models that are likely to be available in each territory. Actual specifications of the boat will be provided when a sales order or enquiry is placed with Maritimo UK Ltd. Specifications for models sold in different markets will vary and specification and models may be changed or withdrawn at any time without prior notice. The individual specification for each vessel will be agreed as part of the sale contract between the purchaser and Maritimo UK Ltd. In some examples here in Maritimo have referred to measurements, specifications or other details applicable to particular territory and no guarantee is given that these are applicable to your chosen territory.